

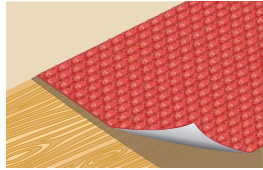

Step 1 Substrate Preparation

A premium polymer-modified thinset mortar is recommended for most PROVA FLEX-HEAT® and porcelain tile installations, but the bonding adhesive must be determined by the type of substrate being used. PROVA FLEX-HEAT® must be installed on substrates that are flat, clean, dry, structurally sound, adequately load bearing, and free from material that may prevent mechanical bonding of the thinset to all installation layers.

Measure, cut, and dry fit PROVA FLEX-HEAT® pieces to fit the installation area when arranged edge to edge. Prepare the substrate by flat troweling the thinset and then combing it with a 1/4" x 1/4" (6 mm x 6 mm) square-notch trowel. Review the PROVA Tile Underlayment Thin Set Coverage document and your mortar manufacturer's specifications for details on mortar usage and quantity estimates.



Step 2 Underlayment Installation

PROVA FLEX-HEAT® must be placed into wet mortar to ensure a transfer of thinset between the substrate and underlayment layers. Climate conditions will greatly affect the mortar's open time.

1. Position PROVA FLEX-HEAT® and firmly embed its anchoring fleece into the thinset.
2. Use a float or flat trowel to work PROVA FLEX-HEAT®, in one direction, into the thinset. Lift one end to check for thinset transfer between the substrate and underlayment. To adjust the alignment of PROVA FLEX-HEAT®, lift one end, pull lightly, and place the underlayment in the appropriate location. Place additional PROVA FLEX-HEAT® sections edge to edge with previous pieces.
3. Ensure that PROVA FLEX-HEAT® is free from any heavy mechanical loads that may loosen it from the substrate or cause damage. Tiling over PROVA FLEX-HEAT® can begin after allowing the mortar to cure for 24 hours.

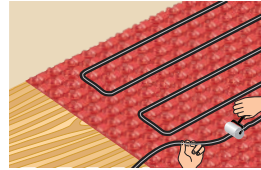

Step 3 Radiant Floor Heating Cable Installation

PROVA FLEX-HEAT® includes studs spaced approximately 1" (2.5 cm) apart, which makes it compatible with several radiant floor heating systems and brands. Please be sure to consult the specifications and installation instructions provided by the manufacturer of your radiant floor heating system to verify its compatibility with PROVA FLEX-HEAT®. In addition to the manufacturer's recommendations, please review the following information:

Notes

- Before securing heating cables in place, consider where the temperature sensors will be placed.
- A hand roller or grout float may help to lock the heating cables in place.

Warnings

1. All radiant floor heating installations with PROVA FLEX-HEAT® must meet the building code requirements in your jurisdiction.
2. Radiant floor heating cables must never cross each other.

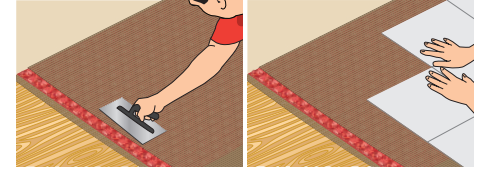

Step 4 Tile Installation

Tiles should be installed over PROVA FLEX-HEAT® with a trowel notch size that matches the type and size of tile being installed.

1. Fill PROVA FLEX-HEAT® cavities with thinset using a flat trowel or the flat side of a notched trowel, taking care not to damage the heating cables. Comb the thinset to ensure it completely covers the underlayment and heating cables. Note that thinset may be flat troweled one day and tile set the next.
2. Back butter the tiles with thinset before setting them in place. Allow the thinset to cure according to the manufacturer's recommendations.
3. Fill grout joints and remove excess grout from all surfaces, including tile edges, with the edge of a float. Allow the grout to cure according to the manufacturer's recommendations. Note that grout is a corrosive product.

Step 1 Substrate Preparation

A premium polymer-modified thinset mortar is recommended for most PROVA FLEX-HEAT® and porcelain tile installations, but the bonding adhesive must be determined by the type of substrate being used. PROVA FLEX-HEAT® must be installed on substrates that are flat, clean, dry, structurally sound, adequately load bearing, and free from material that may prevent mechanical bonding of the thinset to all installation layers.

Measure, cut, and dry fit PROVA FLEX-HEAT® pieces to fit the installation area when arranged edge to edge. Prepare the substrate by flat troweling the thinset and then combing it with a 1/4" x 1/4" (6 mm x 6 mm) square-notch trowel. Review the PROVA Tile Underlayment Thin Set Coverage document and your mortar manufacturer's specifications for details on mortar usage and quantity estimates.

Step 2 Underlayment Installation

PROVA FLEX-HEAT® must be placed into wet mortar to ensure a transfer of thinset between the substrate and underlayment layers. Climate conditions will greatly affect the mortar's open time.

1. Position PROVA FLEX-HEAT® and firmly embed its anchoring fleece into the thinset.
2. Use a float or flat trowel to work PROVA FLEX-HEAT®, in one direction, into the thinset. Lift one end to check for thinset transfer between the substrate and underlayment. To adjust the alignment of PROVA FLEX-HEAT®, lift one end, pull lightly, and place the underlayment in the appropriate location. Place additional PROVA FLEX-HEAT® edge to edge with previous pieces.
3. Ensure that PROVA FLEX-HEAT® is free from any heavy mechanical loads that may loosen it from the substrate or cause damage. Tiling over PROVA FLEX-HEAT® can begin after allowing the mortar to cure for 24 hours.

Step 3 Radiant Floor Heating Cable Installation

PROVA FLEX-HEAT® includes studs spaced approximately 1" (2.5 cm) apart, which makes it compatible with several radiant floor heating systems and brands. Please be sure to consult the specifications and installation instructions provided by the manufacturer of your radiant floor heating system to verify its compatibility with PROVA FLEX-HEAT®. In addition to the manufacturer's recommendations, please review the following information:

Notes:

- Before securing heating cables in place, consider where the temperature sensors will be placed.
- For wires with a gauge size between 0.08"-0.15" (2 mm-4 mm), a three-stud locking loop every 3 feet (0.9 m) may be used to ensure a secure fit and efficient heat distribution.
- A hand roller or grout float may help to lock the heating cables in place.

Warnings:

1. All radiant floor heating installations with PROVA FLEX-HEAT® must meet the building code requirements in your jurisdiction.
2. Radiant floor heating cables must never cross each other.

Step 4 Tile Installation

Tiles should be installed over PROVA FLEX-HEAT® with a trowel notch size that matches the type and size of tile being installed.

1. Fill PROVA FLEX-HEAT® cavities with thinset using a flat trowel or the flat side of a notched trowel, taking care not to damage the heating cables. Comb the thinset to ensure it completely covers the underlayment and heating cables. Note that thinset may be flat troweled one day and tile set the next.
2. Back butter the tiles with thinset before setting them in place. Allow the thinset to cure according to the manufacturer's recommendations.
3. Fill grout joints and remove excess grout from all surfaces, including tile edges, with the edge of a float. Allow the grout to cure according to the manufacturer's recommendations. Note that grout is a corrosive product.

Step 1 Substrate Preparation

A premium polymer-modified thinset mortar is recommended for most PROVA FLEX-HEAT® and porcelain tile installations, but the bonding adhesive must be determined by the type of substrate being used. PROVA FLEX-HEAT® must be installed on substrates that are flat, clean, dry, structurally sound, adequately load bearing, and free from material that may prevent mechanical bonding of the thinset to all installation layers.

Measure, cut, and dry fit PROVA FLEX-HEAT® pieces to fit the installation area when arranged edge to edge. Prepare the substrate by flat troweling the thinset and then combing it with a 1/4" x 1/4" (6 mm x 6 mm) square-notch trowel. Review the PROVA Tile Underlayment Thin Set Coverage document and your mortar manufacturer's specifications for details on mortar usage and quantity estimates.

Step 2 Underlayment Installation

PROVA FLEX-HEAT® must be placed into wet mortar to ensure a transfer of thinset between the substrate and underlayment layers. Climate conditions will greatly affect the mortar's open time.

1. Position PROVA FLEX-HEAT® and firmly embed its anchoring fleece into the thinset.
2. Use a float or flat trowel to work PROVA FLEX-HEAT®, in one direction, into the thinset. Lift one end to check for thinset transfer between the substrate and underlayment. To adjust the alignment of PROVA FLEX-HEAT®, lift one end, pull lightly, and place the underlayment in the appropriate location. Place additional PROVA FLEX-HEAT® edge to edge with previous pieces.
3. Ensure that PROVA FLEX-HEAT® is free from any heavy mechanical loads that may loosen it from the substrate or cause damage. Tiling over PROVA FLEX-HEAT® can begin after allowing the mortar to cure for 24 hours.

Step 3 Radiant Floor Heating Cable Installation

PROVA FLEX-HEAT® includes studs spaced approximately 1" (2.5 cm) apart, which makes it compatible with several radiant floor heating systems and brands. Please be sure to consult the specifications and installation instructions provided by the manufacturer of your radiant floor heating system to verify its compatibility with PROVA FLEX-HEAT®. In addition to the manufacturer's recommendations, please review the following information:

Notes:

- Before securing heating cables in place, consider where the temperature sensors will be placed.
- For wires with a gauge size between 0.08"-0.15" (2 mm-4 mm), a three-stud locking loop every 3 feet (0.9 m) may be used to ensure a secure fit and efficient heat distribution.
- A hand roller or grout float may help to lock the heating cables in place.

Warnings:

1. All radiant floor heating installations with PROVA FLEX-HEAT® must meet the building code requirements in your jurisdiction.
2. Radiant floor heating cables must never cross each other.

Step 4 Tile Installation

Tiles should be installed over PROVA FLEX-HEAT® with a trowel notch size that matches the type and size of tile being installed.

1. Fill PROVA FLEX-HEAT® cavities with thinset using a flat trowel or the flat side of a notched trowel, taking care not to damage the heating cables. Comb the thinset to ensure it completely covers the underlayment and heating cables. Note that thinset may be flat troweled one day and tile set the next.
2. Back butter the tiles with thinset before setting them in place. Allow the thinset to cure according to the manufacturer's recommendations.
3. Fill grout joints and remove excess grout from all surfaces, including tile edges, with the edge of a float. Allow the grout to cure according to the manufacturer's recommendations. Note that grout is a corrosive product.

OPTIONAL APPLICATIONS | APPLICATIONS OPTIONELLES | APLICACIONES OPCIONALES

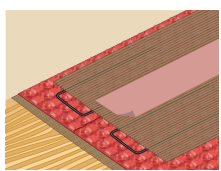

Joints: For areas where high moisture may be present, all joints must be sealed with PROVA JOINT® prior to the installation of tile and after the installation of heating cables: (1) Use a 3/16" x 3/16" (5 mm x 5 mm) notched trowel to apply the thinset in a single step; (2) Set PROVA JOINT® in place and ensure complete coverage of the thinset used between PROVA FLEX-HEAT® and PROVA JOINT®; (3) Install additional pieces of PROVA JOINT® edge to edge with previous pieces, and ensure that there remains a minimum overlap of 2" (51 mm) between each piece of PROVA JOINT®; and (4) Tile the installation before the thinset manufacturer's recommended open time has been reached.

PROVA FLEX-HEAT® must be cut over existing expansion joints. Movement joints should be continued into the tile coverings, and large surface areas should be divided. PROVA TILE EDGE® expansion joints may be incorporated above structural joints.

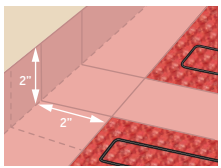

Joints:

For areas where high moisture may be present, all joints must be sealed with PROVA JOINT® prior to the installation of tile and after the installation of heating cables: (1) use a 3/16" x 3/16" (5 mm x 5 mm) notched trowel to apply the thinset in a single step; (2) set PROVA JOINT® in place and ensure complete coverage of the thinset used between PROVA FLEX-HEAT® and PROVA JOINT®; (3) install additional pieces of PROVA JOINT® edge to edge with previous pieces, and ensure that there remains a minimum overlap of 2" between each piece of PROVA JOINT®; and (4) tile the installation before the thinset manufacturer's recommended open time has been reached.

PROVA FLEX-HEAT® must be cut over existing expansion joints. Movement joints should be continued into the tile coverings, and large surface areas should be divided. PROVA TILE EDGE® expansion joints may be incorporated above structural joints.

Joints:

For areas where high moisture may be present, all joints must be sealed with PROVA JOINT® prior to the installation of tile and after the installation of heating cables: (1) use a 3/16" x 3/16" (5 mm x 5 mm) notched trowel to apply the thinset in a single step; (2) set PROVA JOINT® in place and ensure complete coverage of the thinset used between PROVA FLEX-HEAT® and PROVA JOINT®; (3) install additional pieces of PROVA JOINT® edge to edge with previous pieces, and ensure that there remains a minimum overlap of 2" between each piece of PROVA JOINT®; and (4) tile the installation before the thinset manufacturer's recommended open time has been reached.

PROVA FLEX-HEAT® must be cut over existing expansion joints. Movement joints should be continued into the tile coverings, and large surface areas should be divided. PROVA TILE EDGE® expansion joints may be incorporated above structural joints.

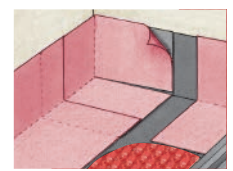

Corners: PROVA CORNER® may be used for corners.

Corners: PROVA CORNER® may be used for corners.

Corners: PROVA CORNER® may be used for corners.